

LED TWEEZER LIGHT

[PEDAL TYPE]

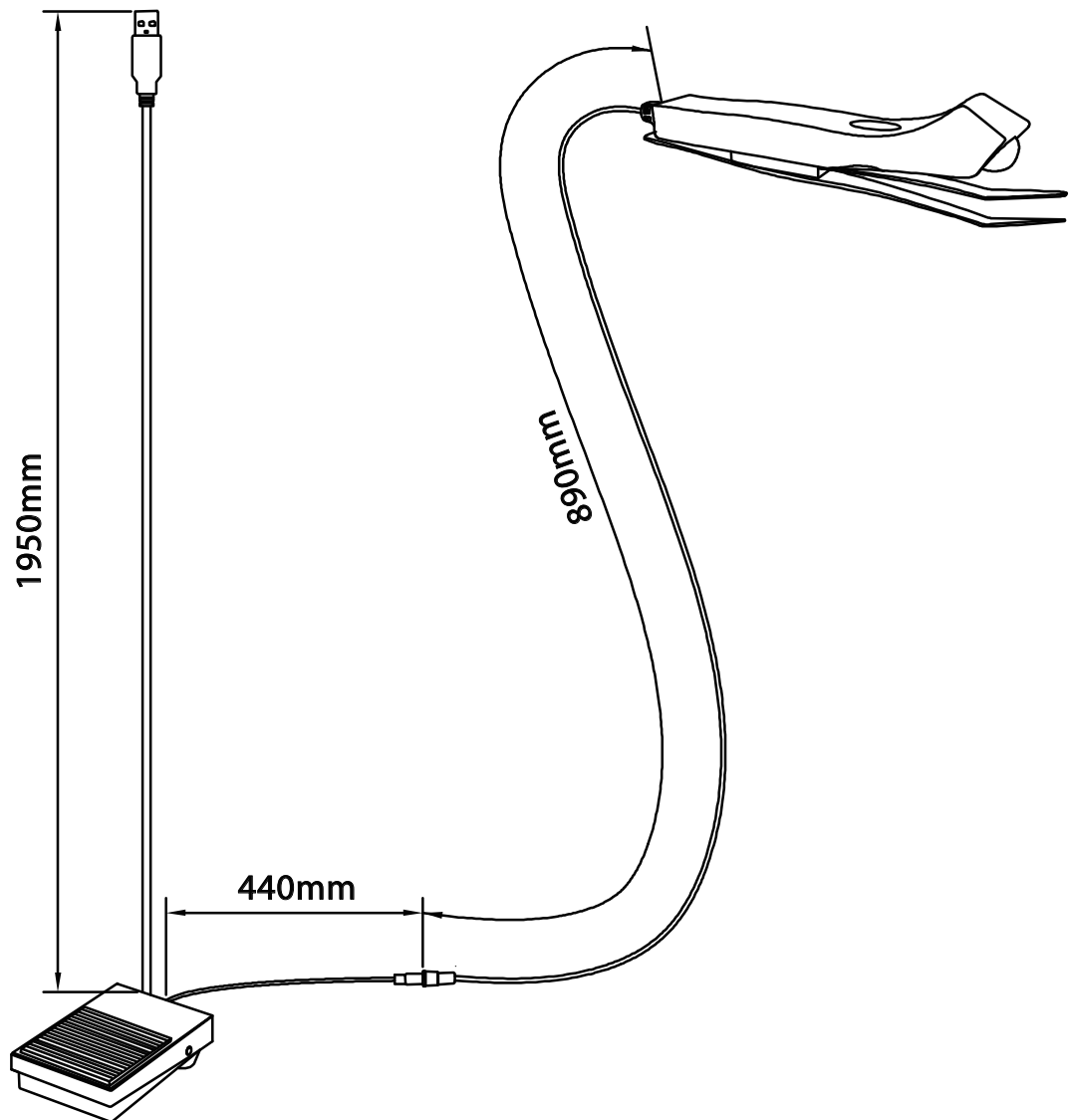

USER MANUAL

Before use, please read the instruction manual carefully and use it correctly.
Please ensure this document is kept secure for future reference.

INSTALLTION

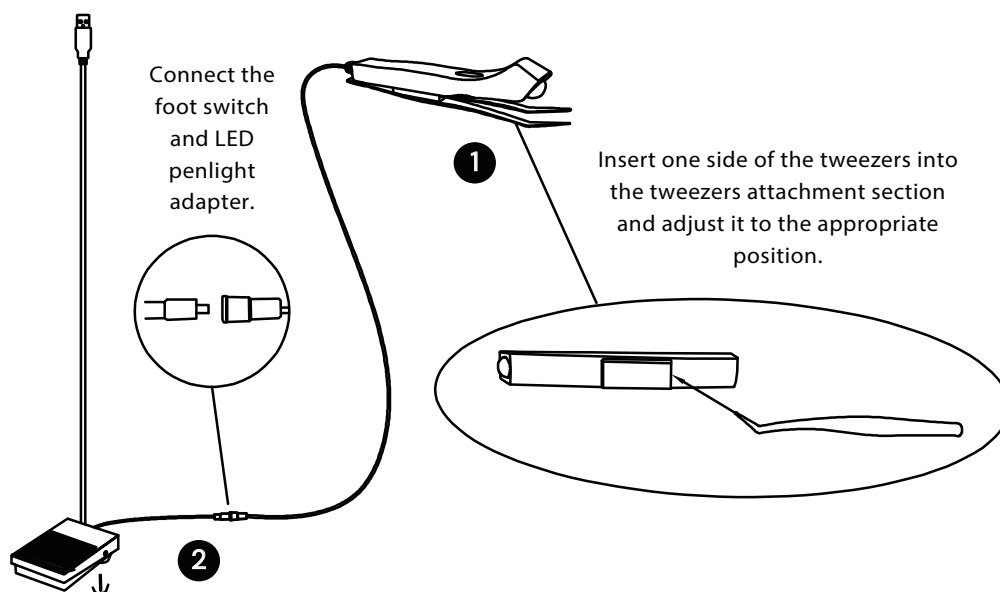

HOW TO USE

1. Connect all the LED penlight and foot switch adapters together.
2. Insert one side of the tweezers into the tweezers attachment part on the side of the LED penlight.
3. Push the blade in so that it touches the light part about 2 cm deep.
4. Plug the USB adapter into a power outlet.
5. Before using it for treatment, press the foot switch to shine light on an object or wall and check that it works properly.
*The light will turn on when you press the foot switch and turn off when you release it.
6. After use, unplug the USB adapter from the outlet and store it properly.

PARAMETER

Model No.	TW001
UV Wave Length	395-400nm
Power	3.5W
Input	5V-1A
Material	Aluminium+ Silicon+ Metal
Operation	Pull Pedal Switch
Color	Black/ White
Contents	Lamp×1, Foot Switch×1, Power Adapter×1, Manual×1

PRECAUTIONS FOR USE

1. This product is curing LED glue for lash extensions only. Do not use for any other purpose.
2. When using the product, the technician should wear protective glasses or blue light-blocking glasses to protect eyes.
3. The person receiving the treatment should have eye sheets or tape on their eyelids to protect their eyes.
4. Do not stare at the illuminated light point.
5. For use only by those with sufficient knowledge and experience.